



Shootout Series Soccer Goals

SKU: 685se535 Installation

WARNING!

It is imperative that all **Portable Soccer Goals** be used only in accordance with safety guidelines contained in these instructions as well as those found on the safety warning labels attached to the goals. Failure to do so can cause serious injury or death.

NOTICE:

**THESE PORTABLE ALUMINUM SOCCER GOALS MEET ASTM F2950-14
SAFETY AND PERFORMANCE STANDARD**

IMPORTANT SAFETY INSTRUCTIONS!

1. Check for structural integrity and proper connection hardware before every use. Replace damaged or missing parts or fasteners immediately.
2. Ensure safety/warning labels are clearly visible.
3. Securely anchor or counterweight movable soccer goals at ALL times following the instructions in this manual.
4. Always instruct players, managers, coaches, trainers, teachers, maintenance and all other personnel who might come into contact with the goal on the safe handling of and potential dangers associated with movable soccer goals.
5. Always exercise extreme caution when moving goals and allow adequate manpower to move goals of varied size and weights. Movable soccer goals should only be moved by authorized and trained personnel.
6. NEVER allow anyone to climb on the net or goal framework.
7. Movable soccer goals should only be used on LEVEL fields, NEVER on a slope or hill area.
8. Remove nets when goals are not in use unless area is secure.
9. Most of the tip over injuries occurred when goals were unattended. Anchor or chain one goal to another or to nearby fence posts, dugouts, or any other similar sturdy fixture when not in use. If this is not practical, store movable soccer goals in a place where children cannot have access to them.
10. Fully disassemble goals for seasonal storage.

- ♦ Inspect all contents prior to installation. Report any missing parts to dealer immediately.
- ♦ Read all instructions before proceeding.

PARTS LIST (FOR ONE PAIR OF GOALS—2 HARDWARE BOXES)					
Item	Qty	Description	Item	Qty	Description
A	2	Crossbar	I	4	Ballast Drum
B	4	Goal Sides (2 LH, 2 RH)	J	4	Plug
C	4	Inner Tube	K	4	Washer
D	4	Connecting Bar	L	2	Front Soccer Warning Label (SCPA#1)
E	16	3/8" Hex Bolt	M	4	Rear Soccer Warning Labels (SCPA#2)
F	4	5/8" Hex Bolt	N	2	Hook and Loop Fastening Strap (Roll)
G	4	5/8" Lock Washer	O	100	Net Attachment Clip
H	2	Backstay Spreader Tube			

1. Slide the *Connecting Bar* (D) into the *Inner Tube* (C) through the channel so that all the holes are lined up as shown. See Figure 1.
2. Lay *Goal Sides* (B) and *Crossbar* (A) on the ground with net attachment tracks facing upward.

NOTE!
THERE ARE LEFT HAND AND RIGHT HAND GOAL SIDES (B).

3. Inserting the inner tube assembly into the *Crossbar* (A) leaving six holes exposed for the *Goal Sides* (B). Install two 3/8" *Hex Bolts* (E) at each end of the *Crossbar* (A). See Figure 1.
4. Attach *Crossbar* (A) to the *Goal Sides* (B), from #1 above, by sliding *Goal Sides* (B) onto the exposed *Inner Tube* (C) and installing two 3/8" *Hex Bolts* (E) per end. See Figures 1 and 3.
5. Fill each *Ballast Drum* (I) completely with sand, making sure the sand is compacted. They should hold approximately 60-70 lbs. of sand each. Once full, install the *Plug* (J) and tighten securely to ensure there is no sand escaping. See Figure 2.

WARNING!
GOAL TIP OVER CAN CAUSE SERIOUS INJURY OR DEATH, PLEASE CAREFULLY READ AND UNDERSTAND THE IMPORTANCE OF THE FILLING INSTRUCTION # 5.

6. On each end of the *Backstay Spreader Tube* (H), with the *Plug* (J) facing inside the goal, slide on one *Ballast Drum* (I), followed by a *Washer* (K).
7. Carefully tip the entire goal assembly into the upright playing position. Using 5/8" *Hex Bolts* (F) and 5/8" *Lock Washers* (G) install the *Backstay Spreader Tube* (H) onto the backstays. See Figures 2 and 3.
8. If not already installed attach *Front Soccer Warning Label* (SCPA#1) (L) to the face of each *Crossbar* (A). Install one *Rear Soccer Warning Label* (SCPA#2) (M) to each tubular backstay at eye level. Replacement warning labels are available without cost by calling Customer Service at 1-800-247-7668.
9. Install *Net Attachment Clips* (O) into the slots in the rear face of the goal, the lower backstay and the *Backstay Spreader Tube* (H) should be spaced approximately 16" - 24" intervals. The *Net Attachment Clips* (O) slip into the slot and twist 90° into position with the opening to the outside of the goal.
10. Drape the net over the backstays and attach to the *Net Attachment Clips* (O) on the rear face of the goal. A rope is woven into the net behind the top front to attach to the left hand and right hand backstays to help support the net. Use roll of *Hook and Loop Net Fastening Strap* (N) to attach net where clips are not present. Cut to length needed.

11. Use of optional soccer post padding is recommended to reduce the risk of player contact injury.

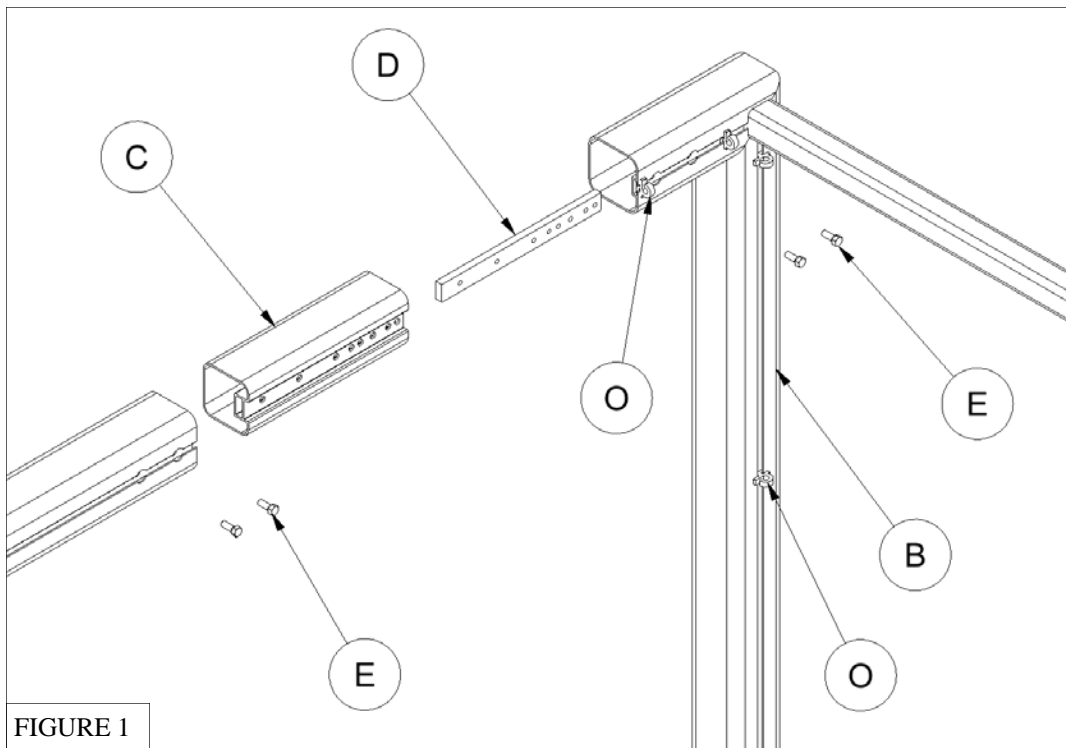

FIGURE 1

REAR WARNING LABEL

WARNING

GOALS MUST BE ANCHORED OR COUNTERWEIGHTED AT ALL TIMES.

UNSECURED GOALS MAY FALL OVER CAUSING SERIOUS INJURY OR DEATH.

APPROVED OPTIONS:

- SECURE WITH AUGER-STYLE GROUND ANCHORS (2 PER GOAL MINIMUM)
- COUNTERBALANCE WITH ATTACHED WEIGHTS ON REAR (125# MINIMUM)
- PURCHASE NO-TIP™ SOCCER GOAL AND FILL BALLAST DRUM COMPLETELY WITH SAND.

For Technical Information
Call
800-247-7668

SCPA#2

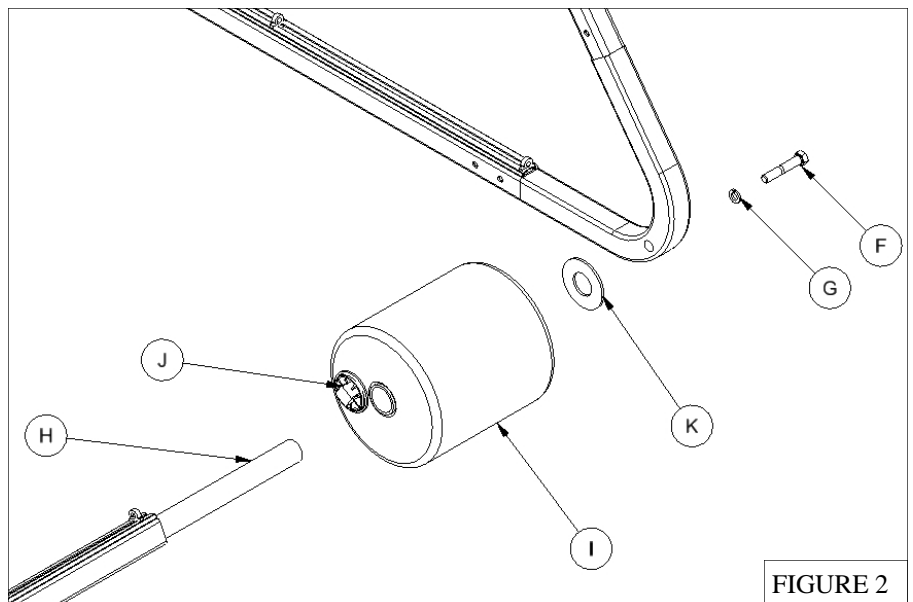

FIGURE 2

FRONT WARNING LABEL

W
A
R
N
I
N
G

For Technical Information
Call
800-247-7668

SCPA#1

ALL SOCCER GOALS

- NEVER CLIMB OR HANG ON GOAL OR NET.
- REGULARLY CHECK ALL FASTENERS PRIOR TO USE.
- CLIMBING, HANGING, TIPPING OR OTHER NON-INTENDED USES OR FAILURE TO PROPERLY INSTALL GOALS CAN CAUSE SERIOUS INJURY OR DEATH.
- CONSIDER PADDING GOAL UPRIGHTS. ASTM F2950-14

PORTABLE SOCCER GOALS

- ALWAYS ANCHOR GOALS ACCORDING TO INSTRUCTIONS.
- DO NOT STORE OR USE ON SLOPED GROUND.
- STORE PORTABLE GOALS TO AVOID UNAUTHORIZED USE.

THIS GOAL MEETS ALL SAFETY AND PERFORMANCE STANDARDS OF ASTM F2950-14

W
A
R
N
I
N
G

3

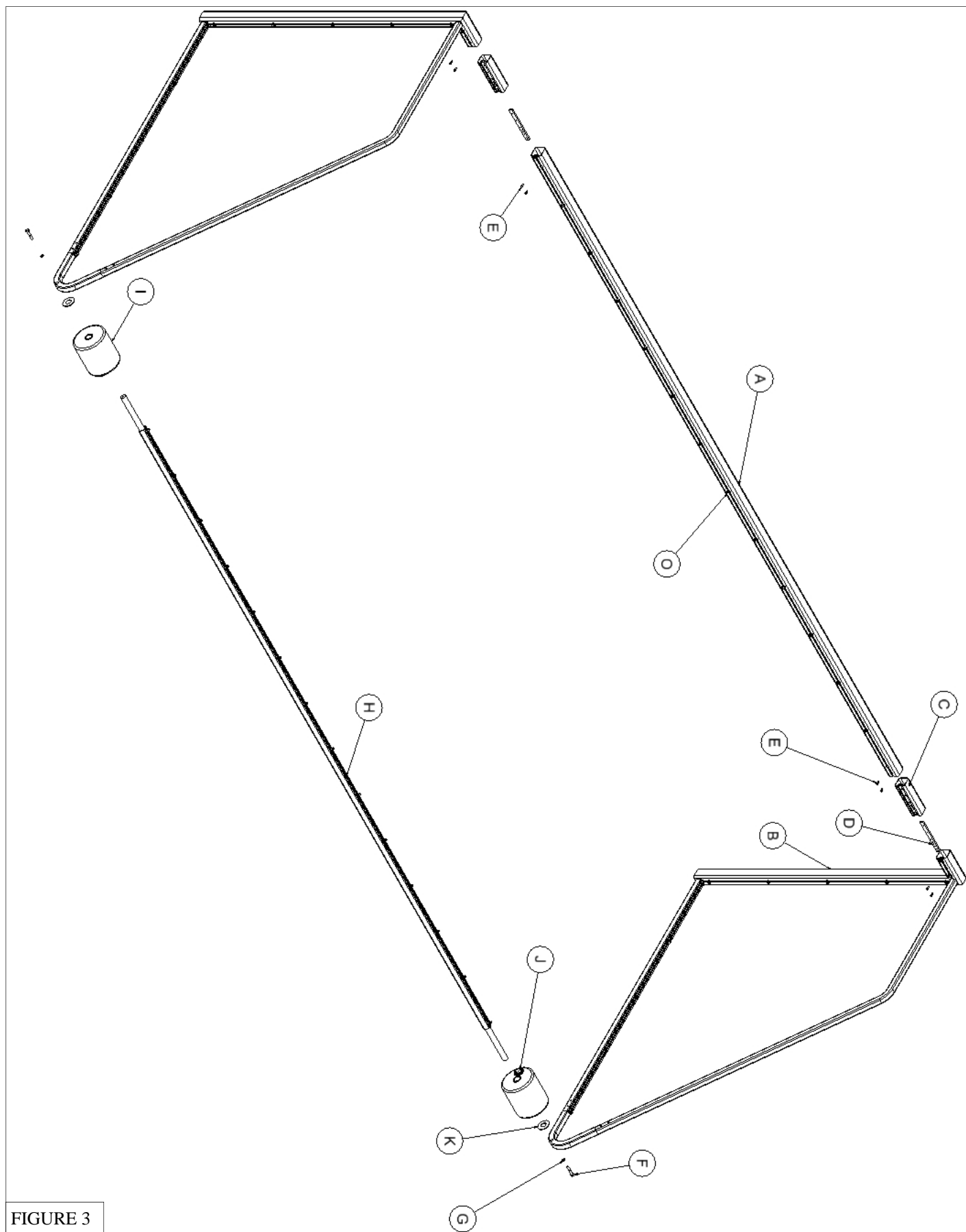

FIGURE 3