

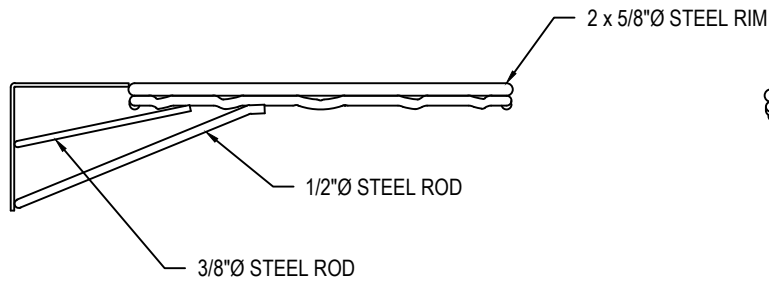

Front Mount - Double-Rim - Basketball Goal

SKU: 685se165 Specs



SIDE

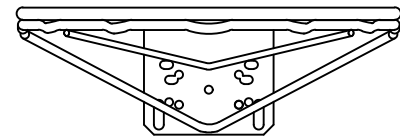

FRONT

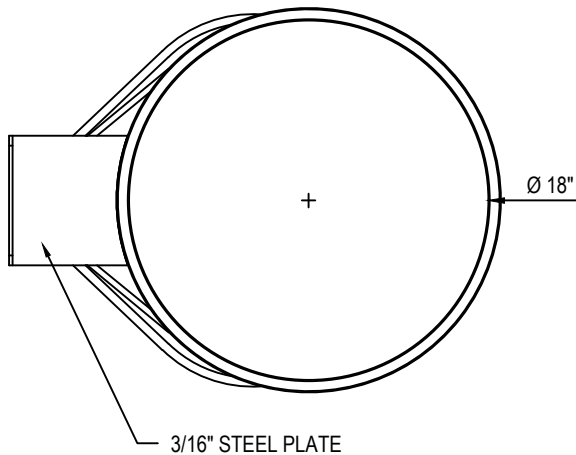

TOP

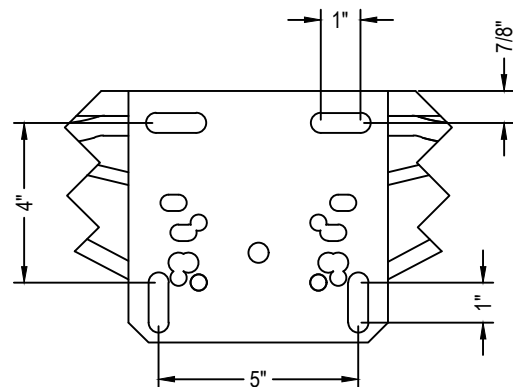

REAR (UNIVERSAL BACKPLATE)

Rim shall consist of an official size 5/8" diameter AISI 1018 cold drawn carbon steel ring and a 1/2" steel ring welded together at no less than six places. The lower ring shall be formed to accept chain nets (included). The back plate shall be a minimum of 3/16" thick punched to mount on all front mount backboards. One 1/2" diameter and one 3/8" diameter rim support shall provide added strength. Mounting hardware shall be included. Rim must have a 1-year limited warranty, an orange powder coated finish and be made in the USA. Installation to be completed in accordance with manufacturer's instructions. Do not scale drawings. Weight approximately 18#.