

5' Bench with Back

SKU: 287be130

parts

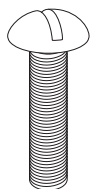
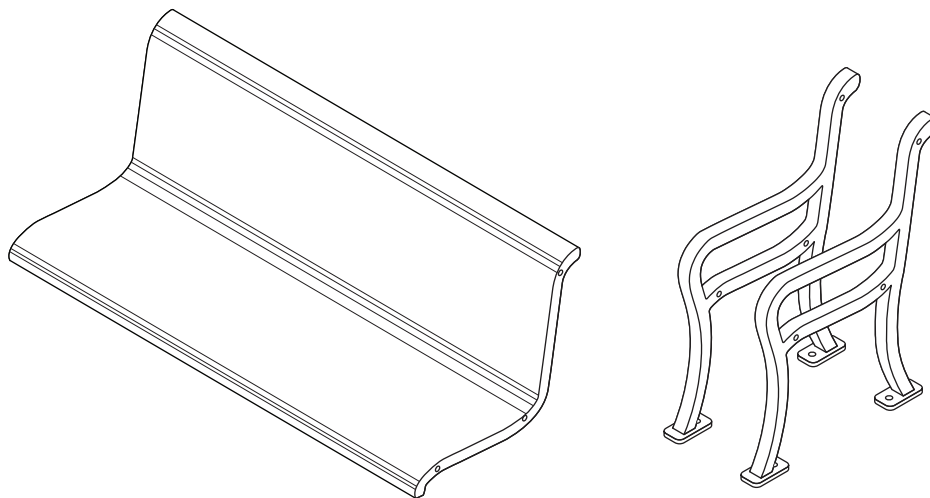

$\frac{5}{16}$ " x $2\frac{1}{2}$ "
Machine Screw

- 6



$\frac{5}{16}$ " Nut

- 6



$\frac{5}{16}$ " Washer

- 6

tools needed

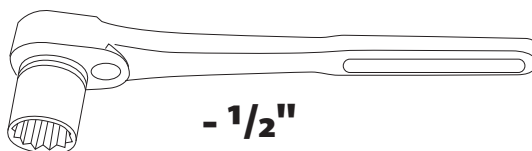
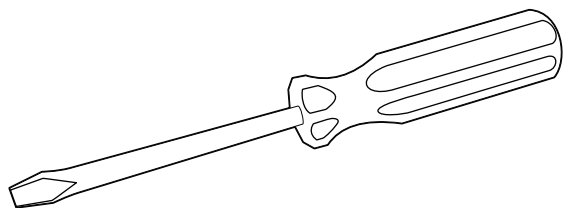

- $\frac{1}{2}$ "

Note: finger tighten all bolts and nuts until parts are adjusted for fit before tightening with tools.

assembly

1

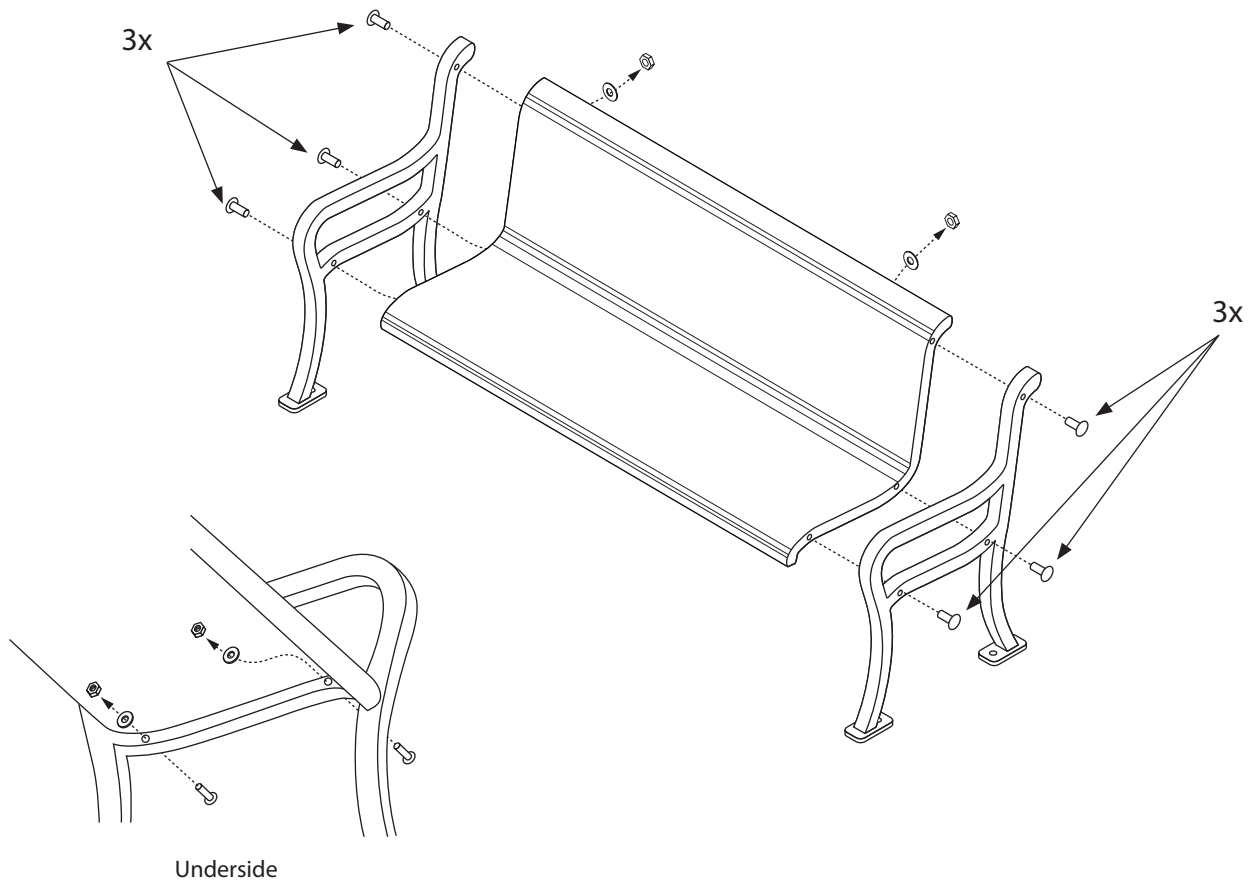

assembly - tighten and finish

2

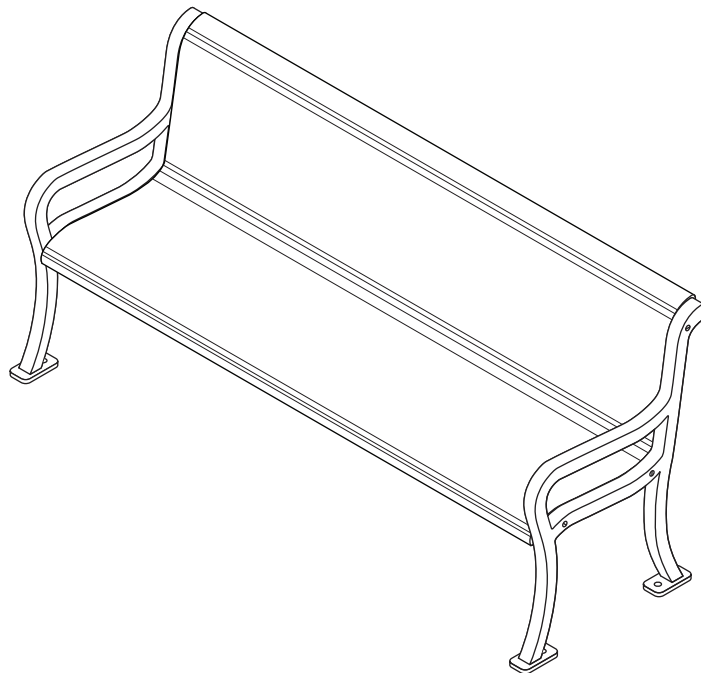

Maintenance: $\frac{5}{16}$ " bolts should be tightened to **8 lbs-ft**. The bench should be serviced annually to verify all bolts are tightened to correct specification and that all other parts are in working order.