

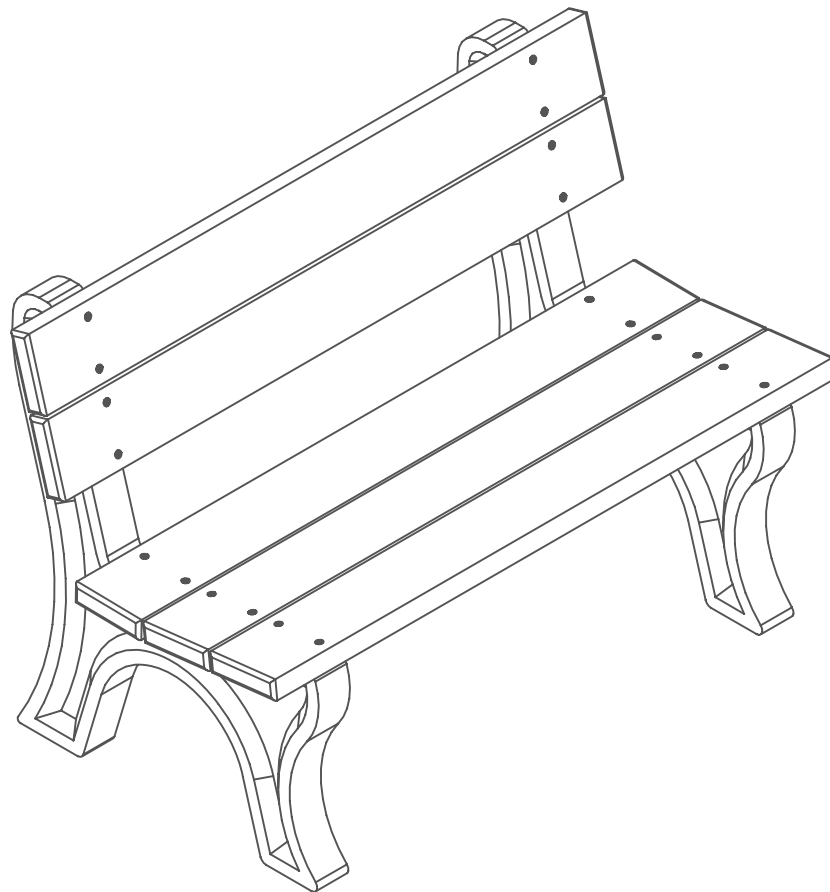

## Traditional Bench - With Back - 4FT



assembly, please make sure all components are included.



**( 1 ) - One Fastener Pack  
FP-TB4B-CU-02**

**FP - Fastener Pack**

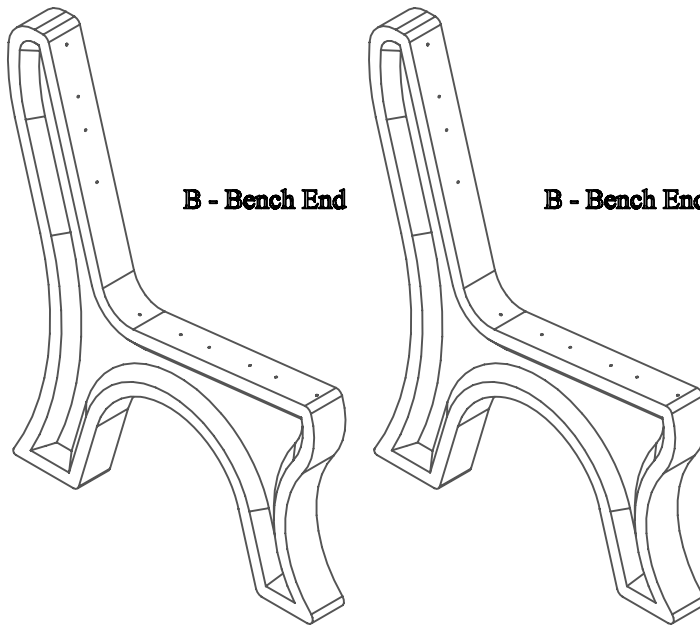

**( 2 ) - Two Bench Ends  
PS-SBBE-T-02**

•	<b>A - Bench Board</b>	•
•	<b>A - Bench Board</b>	•
•	<b>A - Bench Board</b>	•
•	<b>A - Bench Board</b>	•
•	<b>A - Bench Board</b>	•
•	<b>A - Bench Board</b>	•

**( 5 ) - Five Bench Boar  
BP-TB4B-A-02**

c assembly, please make sure all fasteners are included.

20 - #12 x 3" Flat Head Phillips Screw

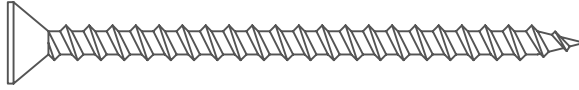

Also needed for this assembly will be the following materials:

1 - #3 Phillips Drive Bit

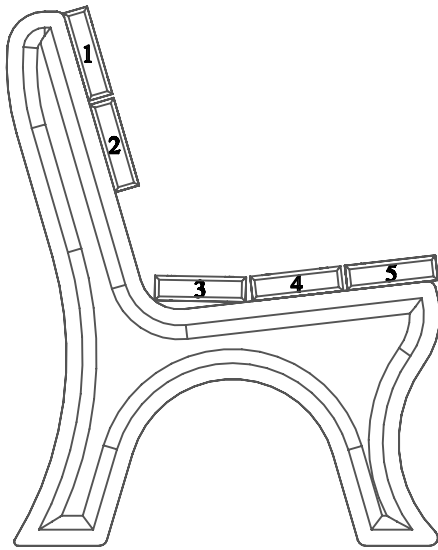

In order to make the assembly of t  
Traditional Bench easier while going  
through the assembly process the  
board positions are numbered and  
will be referenced in later steps.

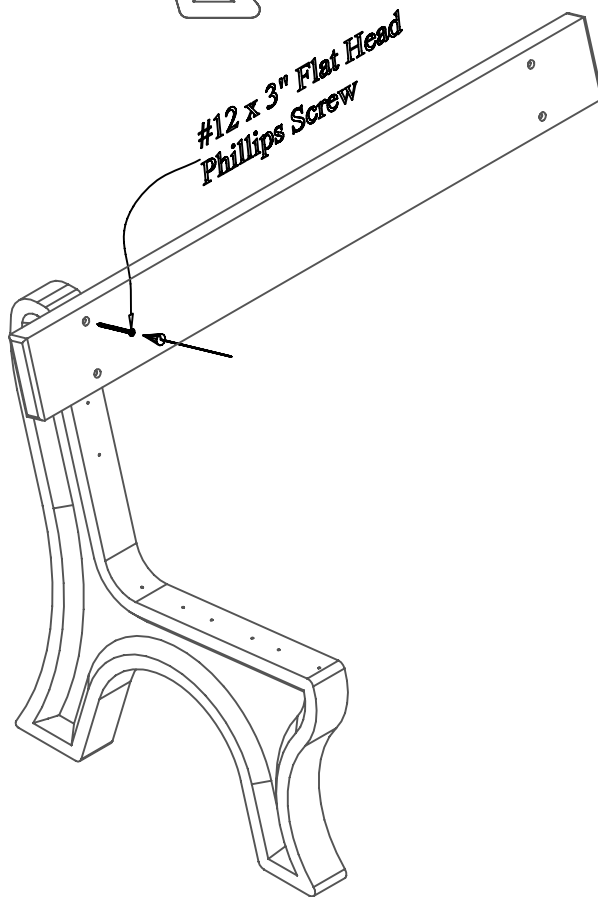

### Step #1:

Stand (1) One bench end upright and place (1) One bench board on position 1 being sure to align the pre-drilled holes to the pilot holes in the bench end. After the holes are properly aligned, fasten with (1) One #12 x 3" Flat Head Phillips Screw in the top pre-drilled hole.

Note: Do not tighten screw completely. This will be done in a later step.

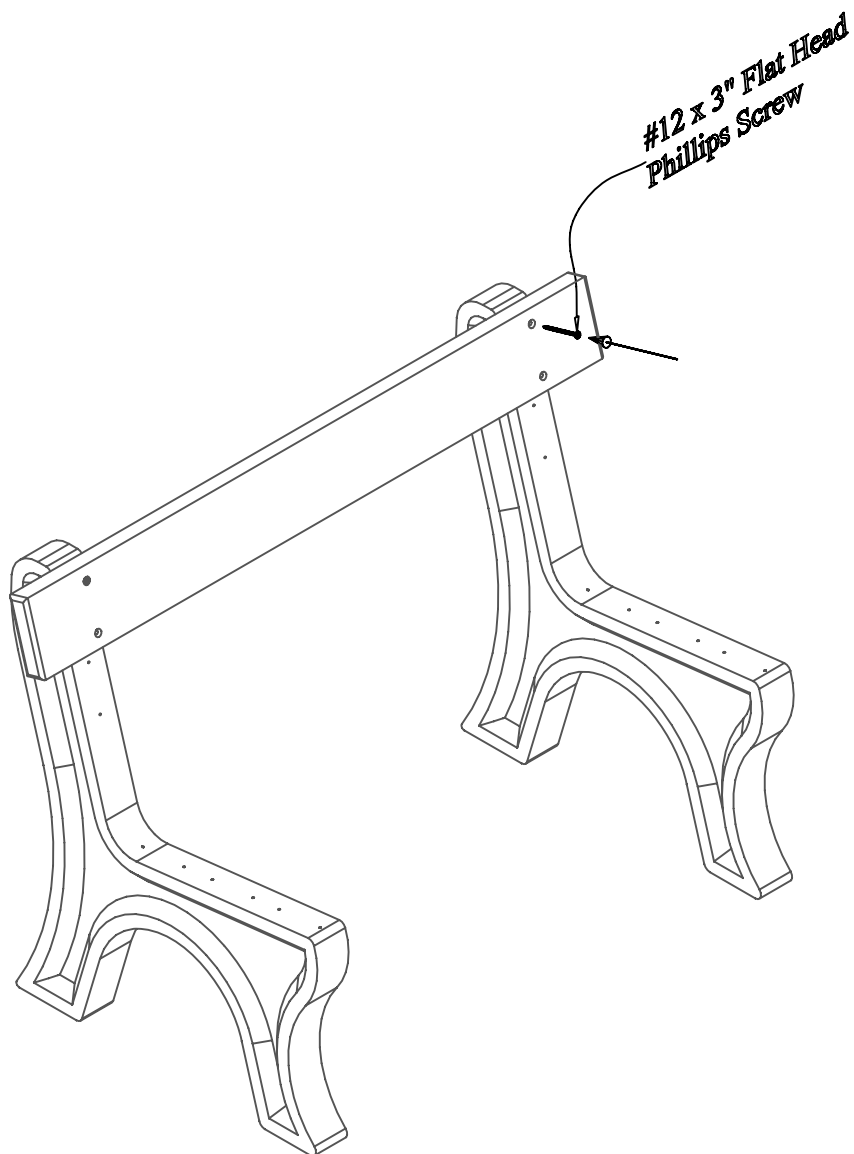

Stand the other bench end upright, and place the bench board already attached to the first bench end, on position 1 being sure to align the pre-drilled holes to the pilot holes in the bench end. After the holes are properly aligned, fasten with (1) One #12 x 3" Flat Head Phillips Screw in the top pre-drilled hole.

Note: Do not tighten screws completely. This will be done in a later step.

Align bottom pre-drilled holes to the pilot holes in the bench end. After holes are properly aligned, fasten with (1) One #12 x 3" Flat Head Phillips Screw per hole.

Note: Be sure to tighten screws completely after this step.

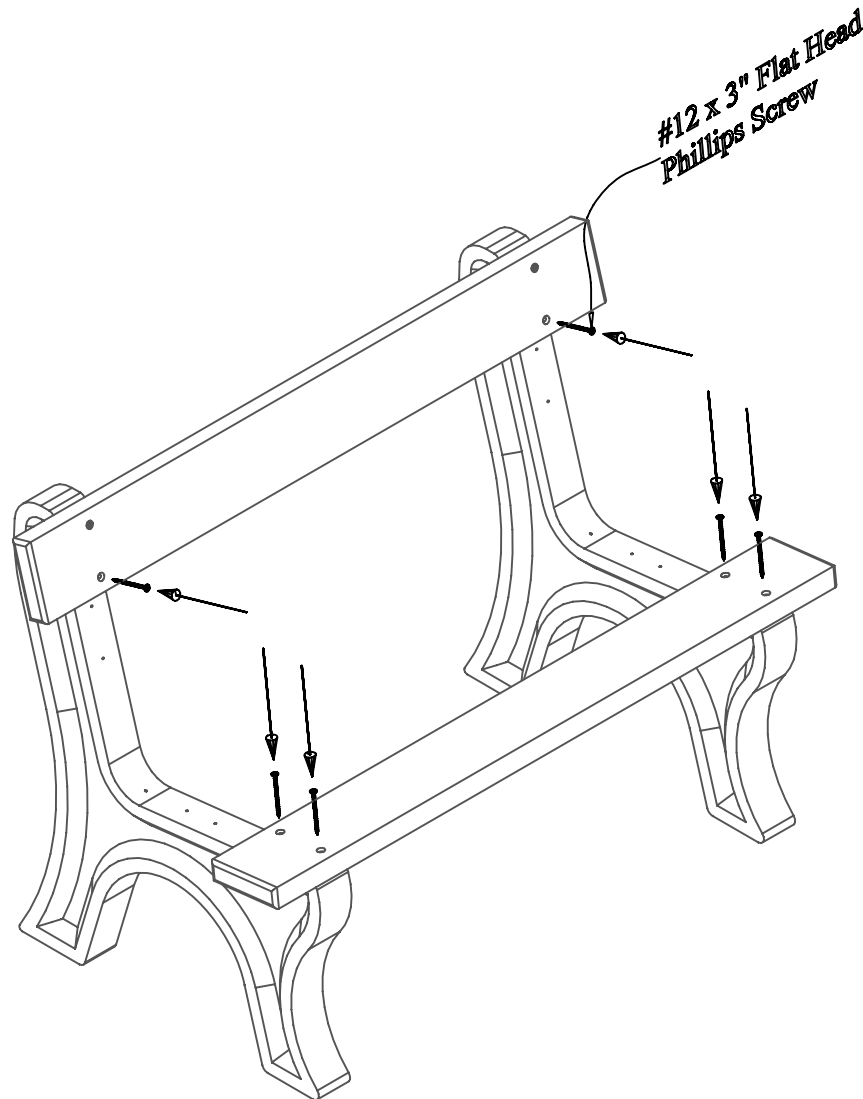

**Step #4:**

Place a second bench board on position 5. Repeat Steps 1 - 3 to attach. Use (1) One #12 x 3" Flat Head Phillips Screw per hole to fasten.

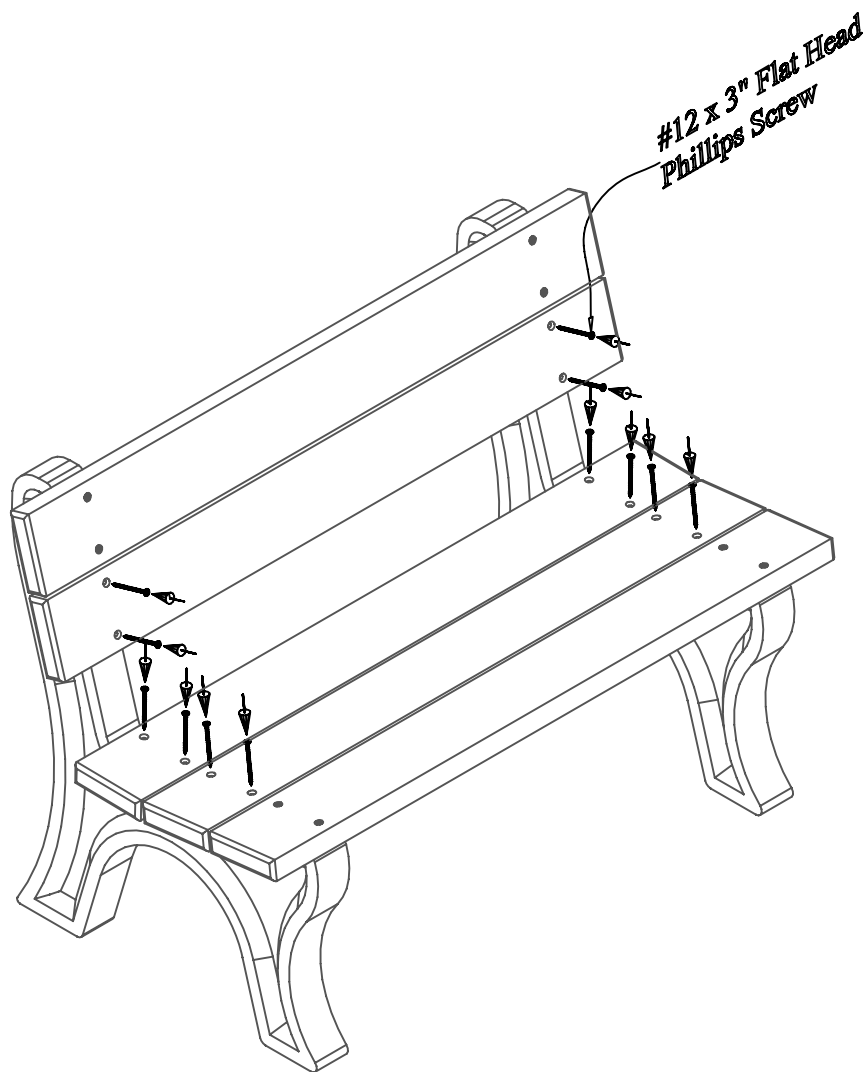

Repeat Steps 1 - 3 to attach bench boards on positions 2, 3 & 4. Use One #12 x 3" Flat Head Phillips Screw per hole to fasten.