

TOWNSHIP BUS SHELTER

- All metal fabricated parts are etched, phosphatized, preheated, primer powder coated, and final coat electrostatically powder coated.
- Colors include: Black, Evergreen, Dark Green White, Tan, Dark Brown, and Blue.
- Special order colors available.
- This product can ship either knocked down or assembled.

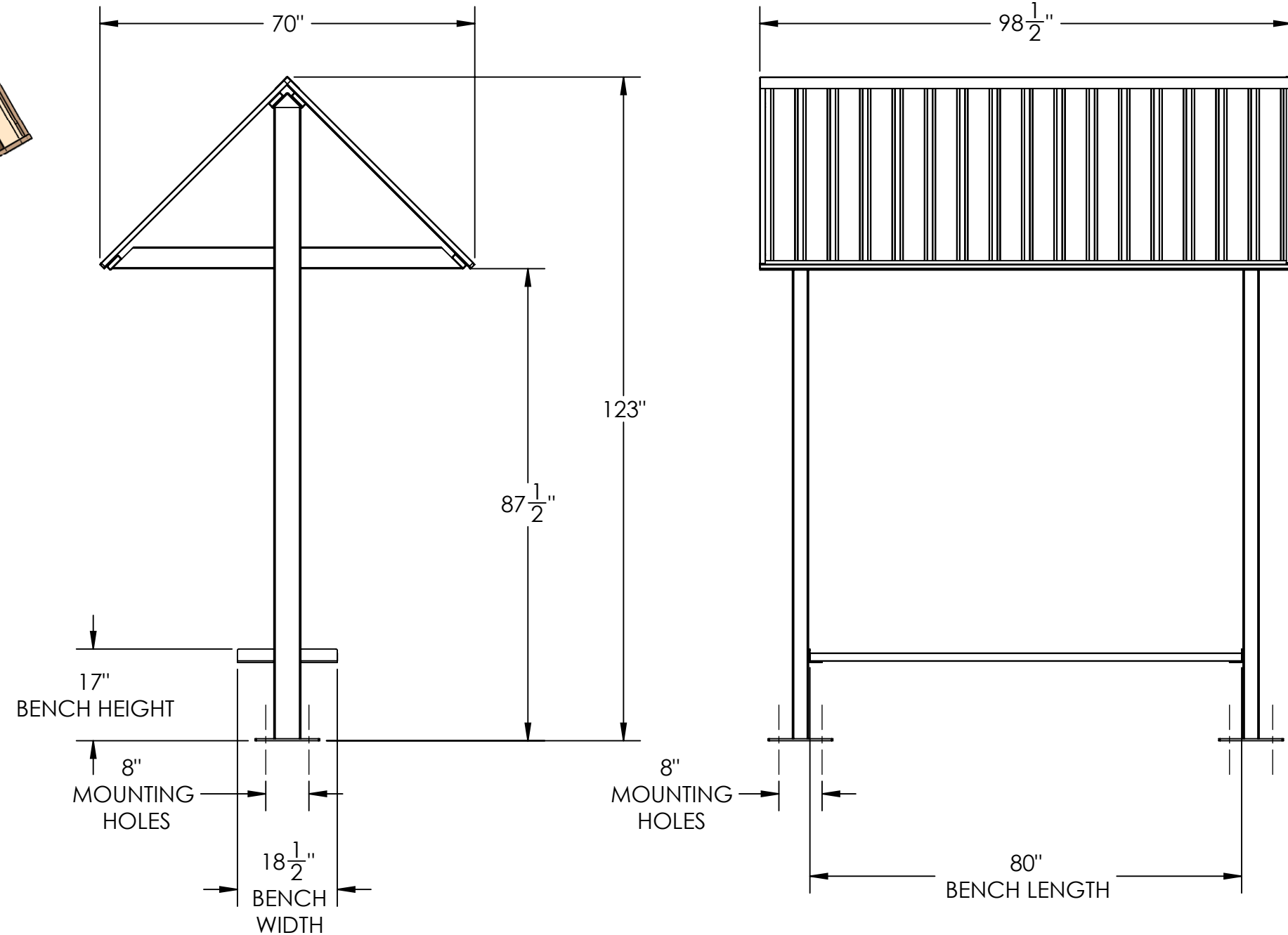

(8) Ø3/4 THRU MOUNTING HOLES



NOTE:
It is not recommended to locate anchor bolts until the shelter is in place.
Anchor bolts not included.

