

Manta Ray

C MAJOR DIATONIC

Features:

- Steel Powder Coated Frame
- Anodized Aluminum Chimes
- Stainless Steel Hardware

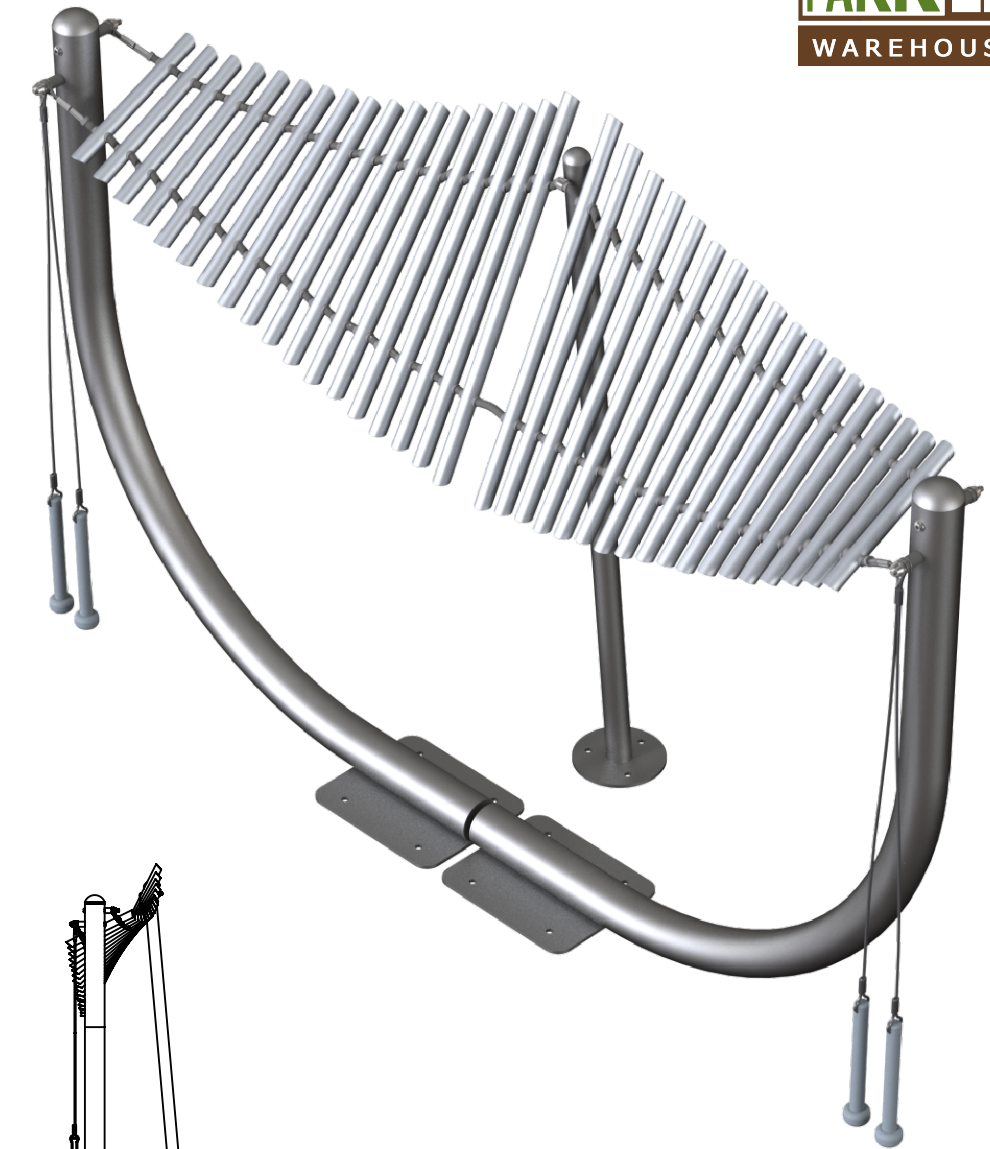
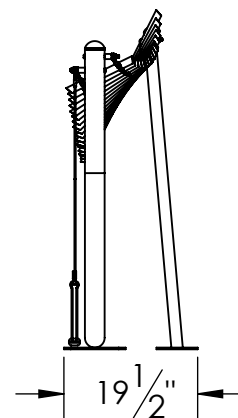
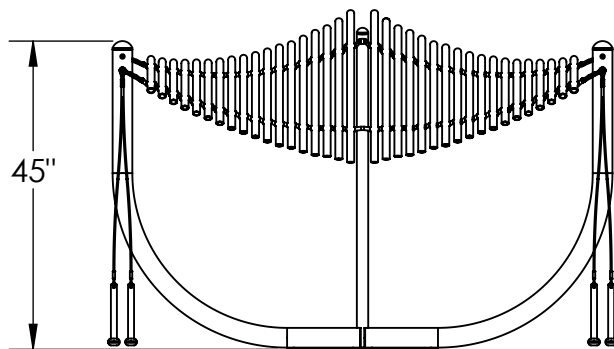
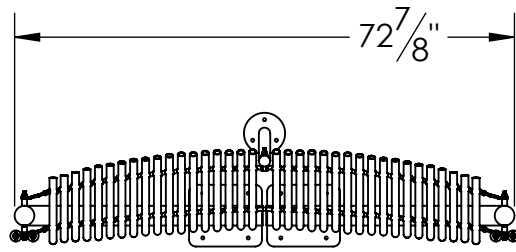

MOUNTING OPTION IDENTIFICATION:

This instrument is offered with various mounting options. Identify your option below and follow installation instructions on the following sheets.

Surface Mount Sheet 3 of 5 (Recommended for ages 5 and up)

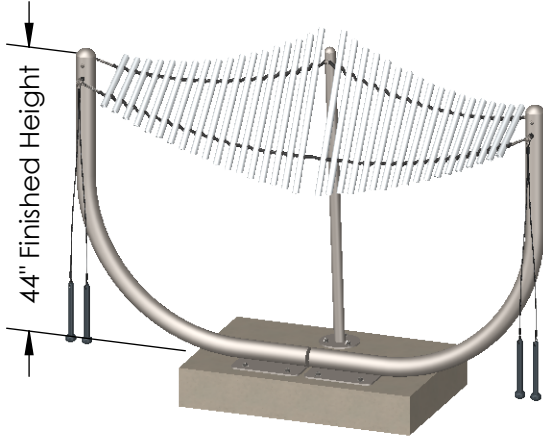

Parts List:

- ☐ Outer Upright (2)
- ☐ Inner Upright (1)
- ☐ Chime Assembly (1)
- ☐ Mallet Assembly (2)
- ☐ 3/8"-16 Tamper-Resistant Nut (5)
- ☐ #30 Square-Drive Socket (1)
- ☐ 3/8"-16, 5" lg. Socket Cap Screw (4)
- ☐ ϕ 3/8" ID Washer (10)
- ☐ 1 1/2" Spacer (2)
- ☐ 1 3/16" Spacer (2)
- ☐ ϕ 3/8" x 3 3/4" Anchor Bolt (11)
- ☐ Plastic Anchor Cap (11)
- ☐ Blue Locktite (1)

Weights:

Boxed Instrument Weight, 140 lbs.

In-Ground Mount Sheet 3 of 5 (Recommended for ages 3 and up)

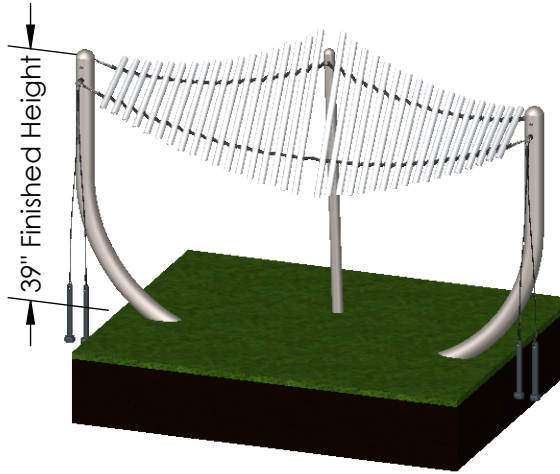

Parts List:

- ☐ Outer Upright (2)
- ☐ Inner Upright (1)
- ☐ Chime Assembly (1)
- ☐ Mallet Assembly (2)
- ☐ 3/8"-16 Tamper-Resistant Nut (5)
- ☐ #30 Square-Drive Socket (1)
- ☐ 3/8"-16, 5" lg. Socket Cap Screw (4)
- ☐ ϕ 3/8" ID Washer (10)
- ☐ 1 1/2" Spacer (2)
- ☐ 1 3/16" Spacer (2)
- ☐ ϕ 3/8" x 3 3/4" Anchor Bolt (11)
- ☐ Plastic Anchor Cap (11)
- ☐ Blue Locktite (1)

Weights:

Boxed Instrument Weight, 140 lbs.

Portable Mount Sheet 4 of 5 (Recommended for ages 5 and up)

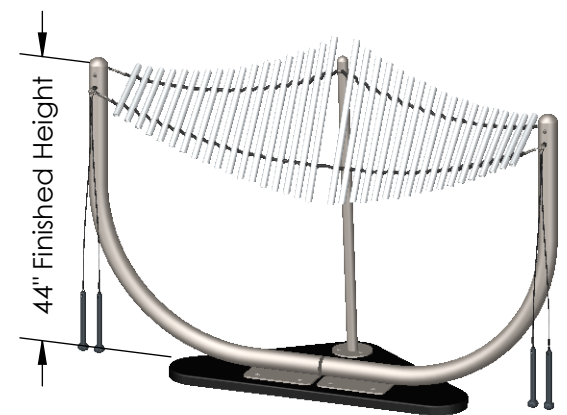

Parts List:

- ☐ Outer Upright (2)
- ☐ Inner Upright (1)
- ☐ Chime Assembly (1)
- ☐ Mallet Assembly (2)
- ☐ 3/8"-16 Tamper-Resistant Nut (5)
- ☐ #30 Square-Drive Socket (1)
- ☐ 3/8"-16, 5" lg. Socket Cap Screw (4)
- ☐ ϕ 3/8" ID Washer (10)
- ☐ 1 1/2" Spacer (2)
- ☐ 1 3/16" Spacer (2)
- ☐ 3/8"-16, 1 1/2" lg. Socket Cap Screw (11)
- ☐ Portable Stand (1)
- ☐ Blue Locktite (1)

Weights:

Boxed Instrument Weight, 140 lbs.

Boxed Portable Stand Weight, 40 lbs.

SURFACE AND IN-GROUND MOUNT INSTALLATION PROCEDURES

Step 1: Determine installation location. Verify concrete footing is a minimum of 36" long x 24" wide x 6" thick. If the concrete pad is at an angle, steel washers are required to act as shims. (Shims not provided) (If a In-Ground appearance is desired recess the concrete pad 4" below finished grade)
Allow concrete to cure per concrete manufacturers guidelines.

Step 2: With two people place the Uprights individually onto the concrete pad and mark the center of the holes on the surface mount plate. Use the diagram below as a guide for Upright placements. After you have made your marks, set aside the Uprights in order to drill for anchor holes. With a hammer or rotary drill, drill through concrete at marked locations. Drill to a minimum depth of 4". A 3/8" masonry drill bit will be needed.

Step 3: Place the Uprights back over the drilled out holes. Insert provided anchor bolts into aligned holes. Position anchor nut so that it is flush with the top of the bolt. Pound anchor bolts into the hole until the anchor washer is flush with the upright bases. Tighten anchor bolts until they are snug. Cover remaining bolt sections with provided plastic caps.

Step 4: Verify the correct placement, levelness, plumbness, and finished height of the instrument. Also check for sufficient clearance around the instrument. A 36" radius is recommended around the instrument for wheelchair accessibility, however this is not required for instrument function. Instrument may be installed next to a wall or in a variety of different configurations. Refer to sheet 5 of 5 for Chime Assembly installation.

Step 5: If installing onto wet concrete, us the wet set anchor manufacturers guidelines for installation procedures.

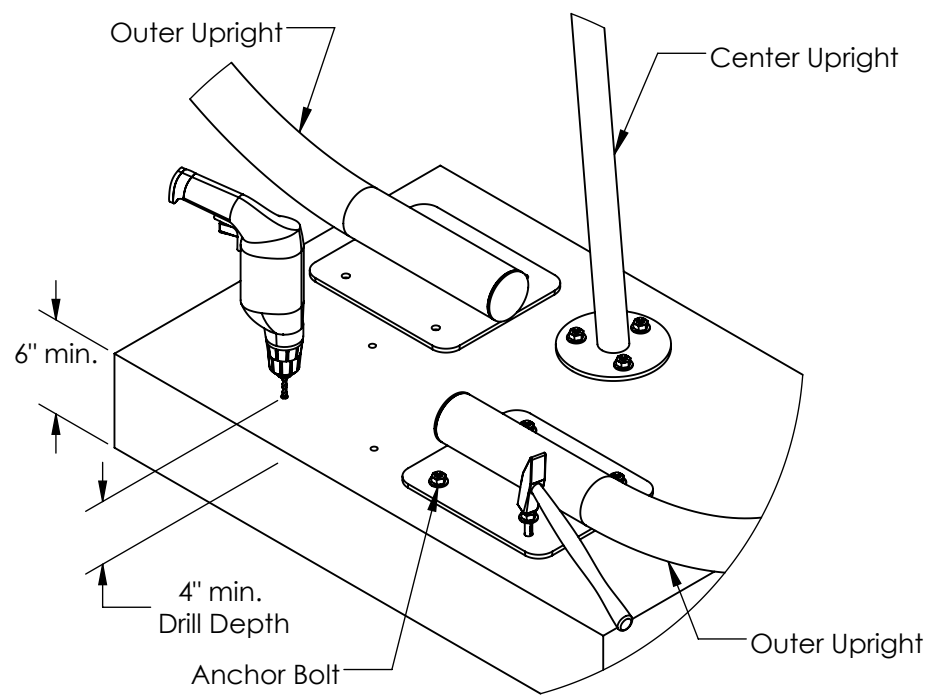
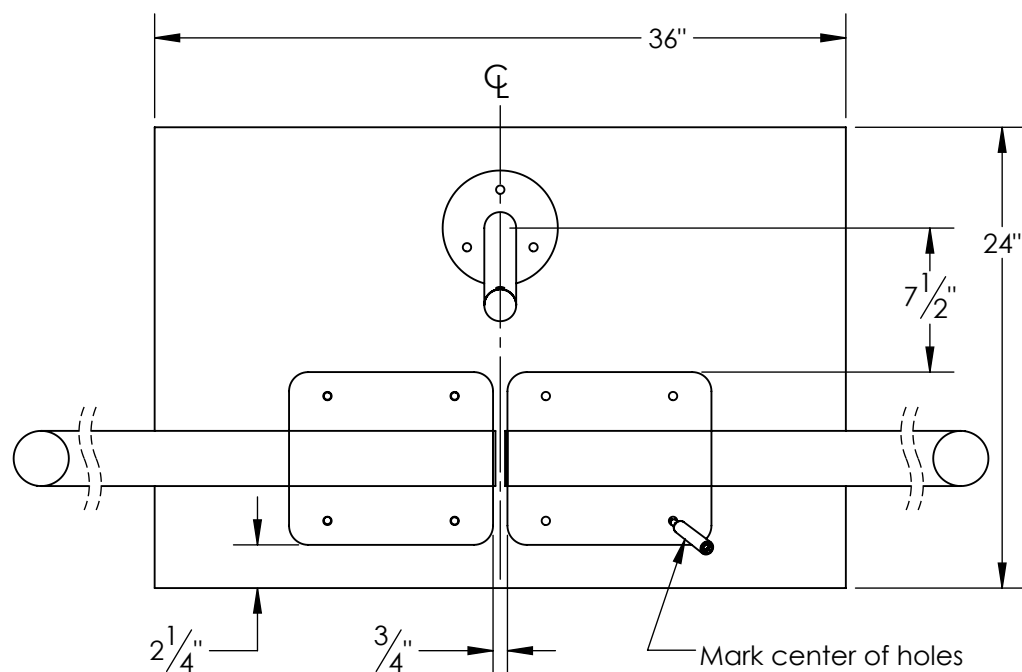

PORTABLE MOUNT INSTALLATION PROCEDURES

Step 1: With two people place the Uprights individually onto the Portable Stand and fasten down each piece to the portable stand with the provided 3/8"-16, 1 1/2" lg. Socket Cap Screws. The Cap Screws should pass through the Uprights base plates, through their corresponding holes on the Portable Stand, and thread into the recessed square nut on the underside Portable Stand.

Step 2: Refer to sheet 5 of 5 for Chime Assembly installation.

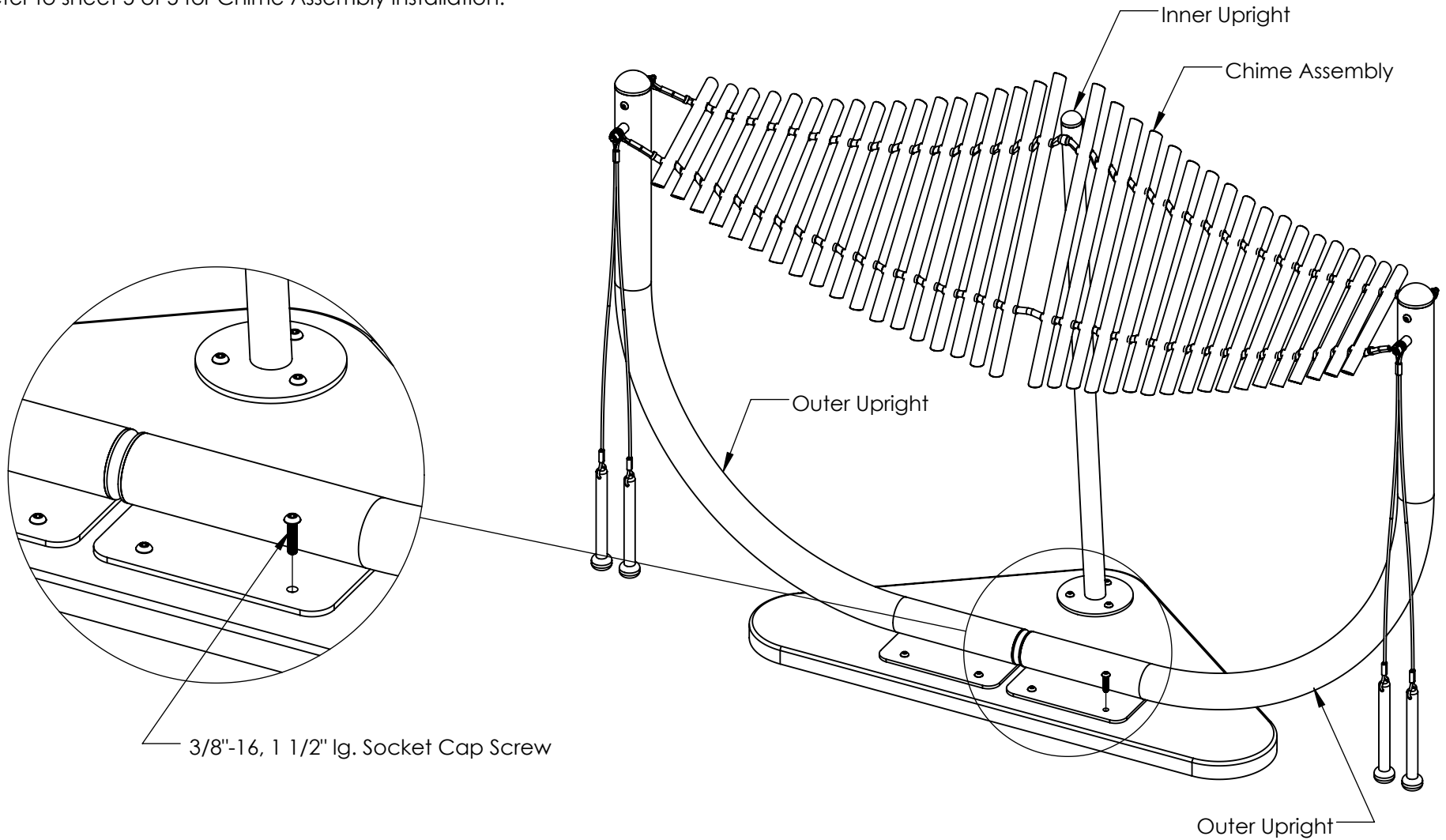

CHIME ASSEMBLY INSTALLATION PROCEDURES

Step 1: After the Inner and Outer Uprights have been properly installed attach the Chime Assembly to the Uprights.

Step 2: Follow the diagrams below for installation of the Chime Assembly. Before installing the tamper-resistant nuts, apply the provided blue locktite to the threads of the 5 bolts on the Chime Assembly. After the blue locktite is applied, fasten down nuts with the provided #30 Square-Drive Socket.

