

King of the Hill

SAFETY WARNINGS & EQUIPMENT INSPECTION

- Owners and installers please note these safety warnings and make use of this checklist on a regular basis.
- Follow installation instructions when erecting equipment.
- Ground surfaces around equipment should be restored as needed. Concrete footings should never be exposed. Surface depth should comply with ASTM and CPSC specifications.
- Check for and repair damage caused by wear or vandalism, a major factor in injury causing situations.
- All protruding bolts should be covered or cut off and finished smooth. Sharp edges on pipes should be capped or removed. Check for bent, broken, or severely worn pipe, and replace.
- All equipment should be free of rust and repainted whenever necessary to deter rusting.
- We provide our customers with layout sheets and installation instructions. Please keep on file the specifications sheet that contains the listing of every part used.
- Never add components not intended for use with this product.
- Regular maintenance is necessary in this and all park and recreational equipment to insure the safety of the user.
- Note: Proper maintenance of equipment requires regular tightening of all bolts, nuts, and setscrews.
- Note: Regular checking of all parts, castings, etc. should be made. If a part is broken or worn, it should be replaced immediately.
- Check to be sure all fittings are tight and that bars and pipes do not move.
- Replace all worn S-hooks. S-hooks must be completely closed. Failure to close S-hooks can result in serious injury to the user. NEVER reuse S-hooks.
- Test for free movement of swing hanger and other moving attached parts.
- Check for worn chains and replace them.
- A soft resilient surface should be placed under all swings extending at least twice the height of the top rail both front and back.

HARDWARE

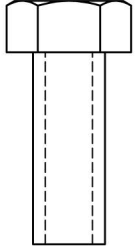

3/8" x 1"
Machine Bolt

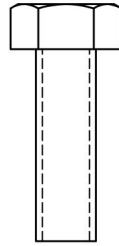

5/16" x 1"
Machine Bolt

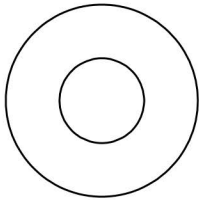

3/8" Washer

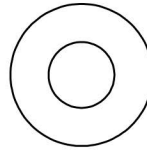

5/16" Washer



5/16" Kep Nut

TOOLS REQUIRED

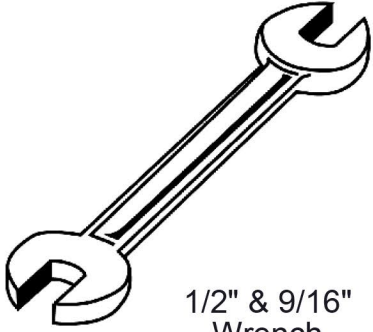

1/2" & 9/16"
Wrench



1/2" & 9/16"
Socket Wrench

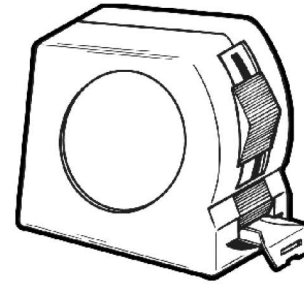

Tape Measure

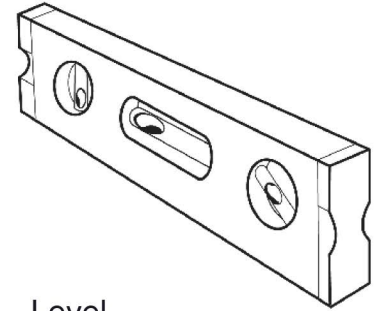

Level

BARK PARK PRODUCT SPECIFICATIONS



King of the Hill

Planking: 12 gauge sheet steel. 7 gauge x 1-1/2" flat bar understructure. Electrically MIG welded. 1" x 2" rectangular steel tubing is bolted to top surface to create steps.

Coating: Oven fused functionalized polyethylene copolymer-based thermoplastic. Fluidized bed coating application with superior mechanical performance, impact resistance and UV-stability. Steel walking planks feature BarkPark's proprietary CanineCoat™, a thermoplastic coating that has been specially developed to provide superior slip-resistant traction for dog's paws.

Frame: 1-5/8" O.D. x 14 gauge pre-galvanized structural steel tubing.

Frame Coating: Electrostatic powder coated application oven cured.

Hardware: All stainless steel hardware fasteners.

Dimensions: Outside to outside dimensions are 127 1/2" long x 30" wide x 48" tall.

COMPONENTS

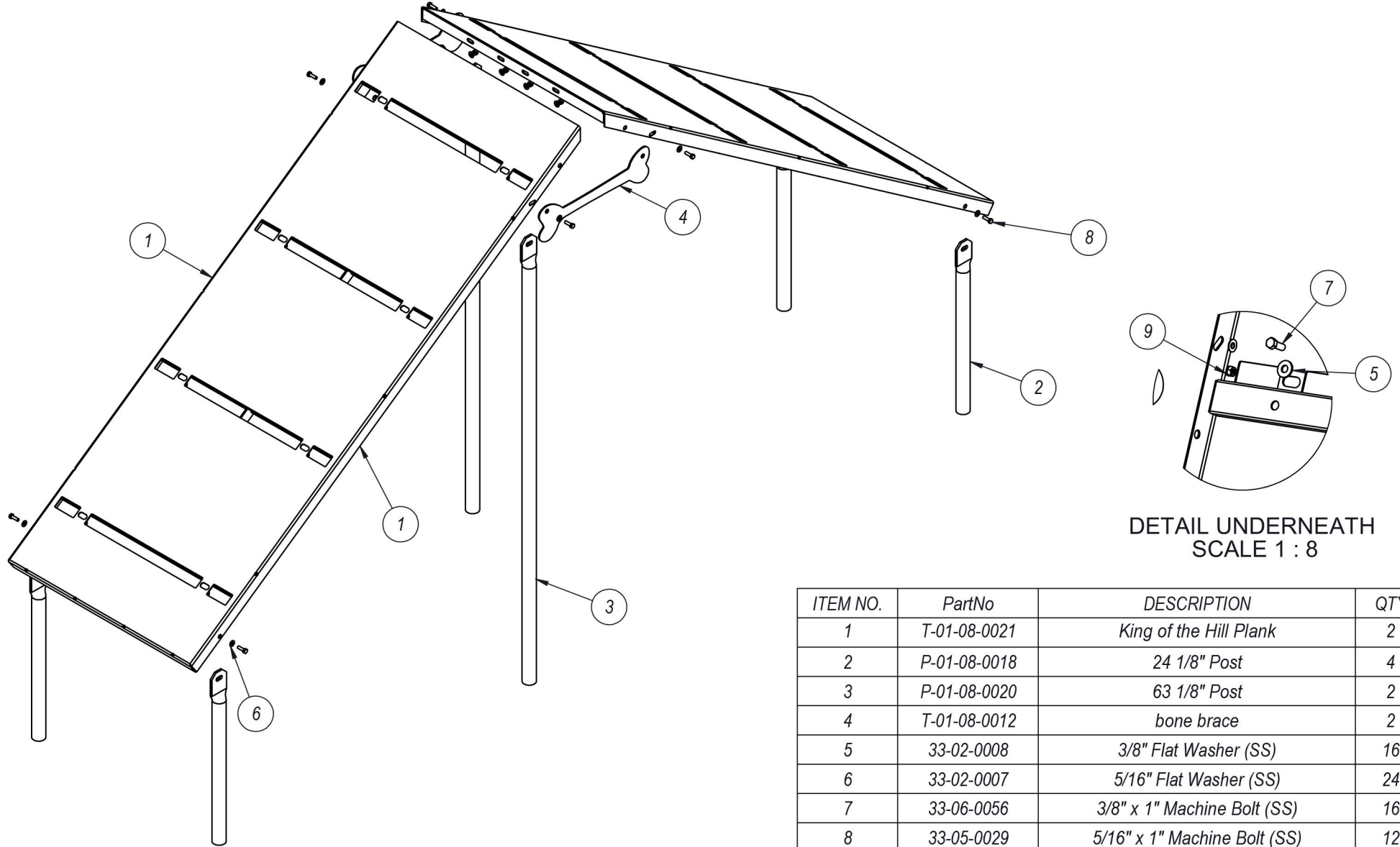

ITEM NO.	PartNo	DESCRIPTION	QTY
1	T-01-08-0021	King of the Hill Plank	2
2	P-01-08-0018	24 1/8" Post	4
3	P-01-08-0020	63 1/8" Post	2
4	T-01-08-0012	bone brace	2
5	33-02-0008	3/8" Flat Washer (SS)	16
6	33-02-0007	5/16" Flat Washer (SS)	24
7	33-06-0056	3/8" x 1" Machine Bolt (SS)	16
8	33-05-0029	5/16" x 1" Machine Bolt (SS)	12
9	33-03-0012	5/16" Kev Nut (SS)	12
10	T-01-08-0022	bark park step strip	8

STEP 1

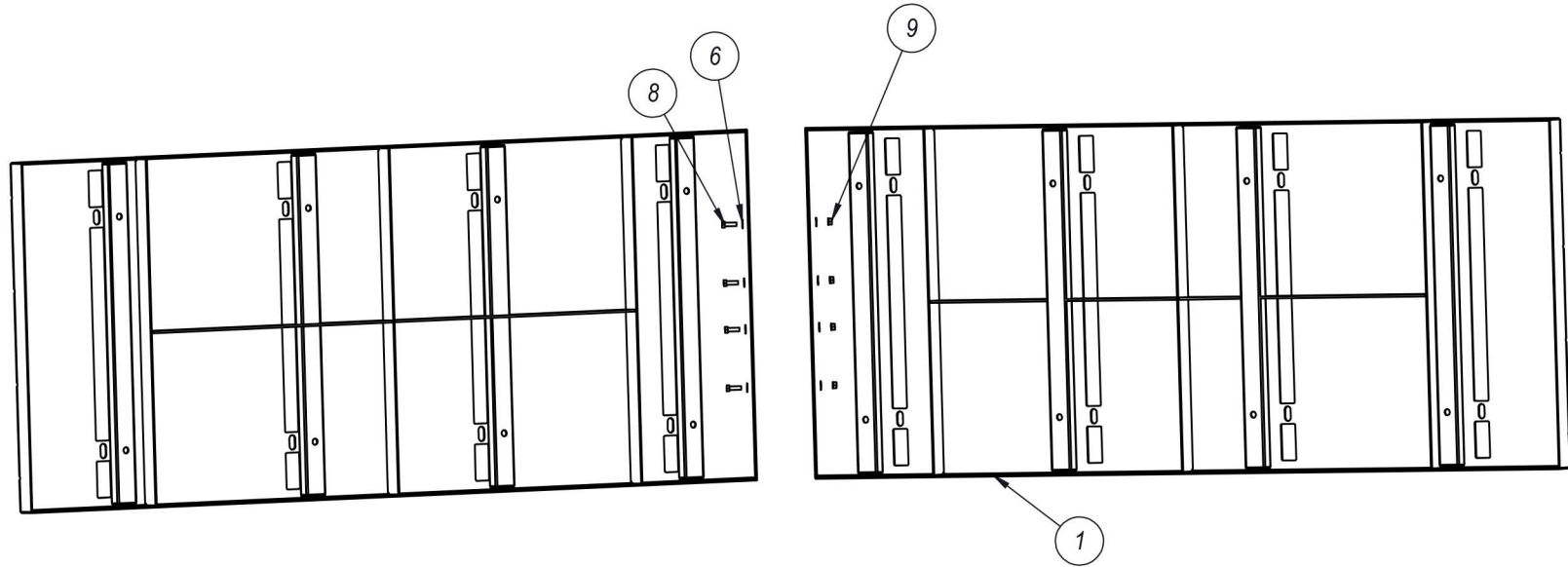

Bolt King of the Hill Planks together using specified hardware. (This is done best laying on its side.)

STEP 2

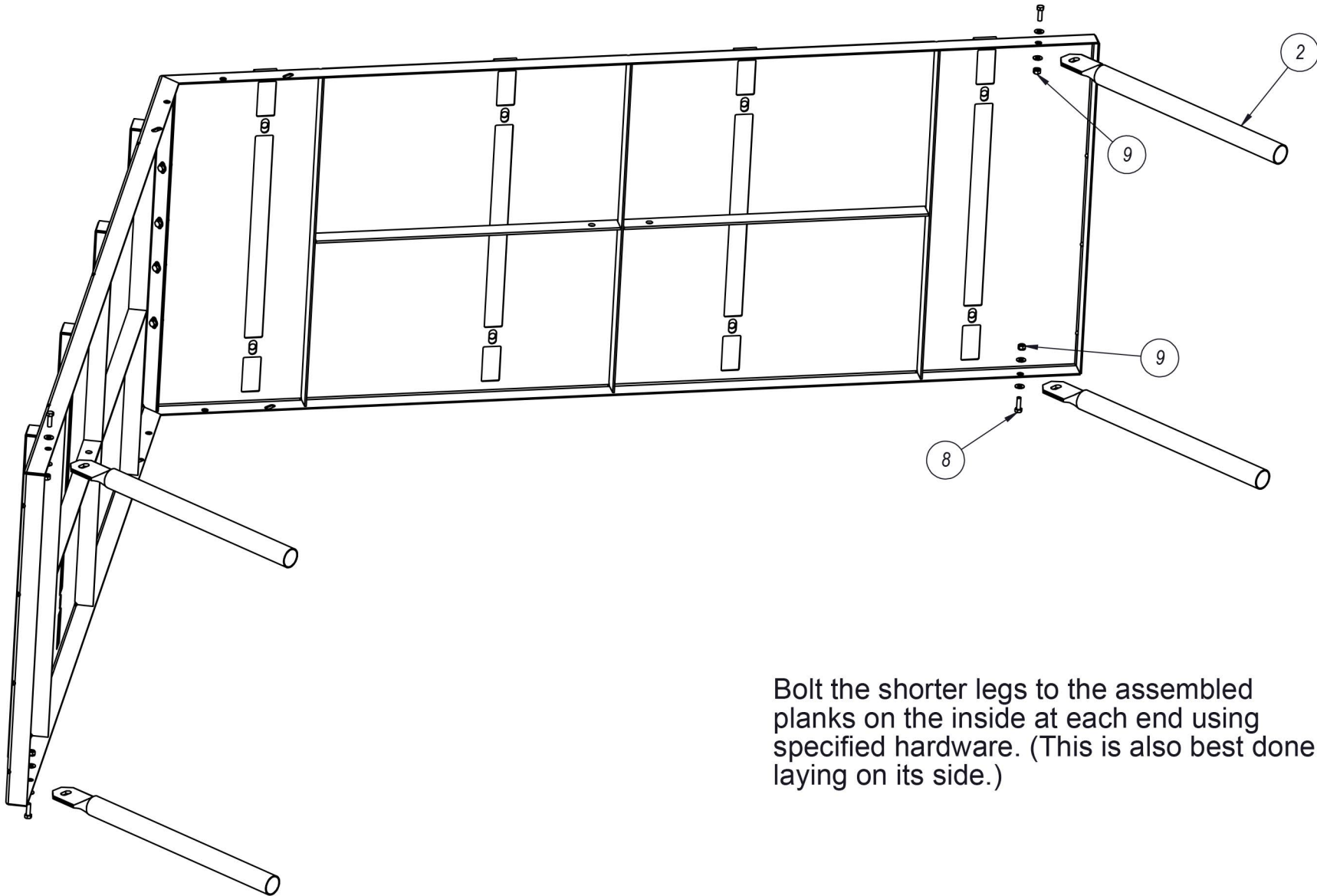

Bolt the shorter legs to the assembled planks on the inside at each end using specified hardware. (This is also best done laying on its side.)

STEP 3

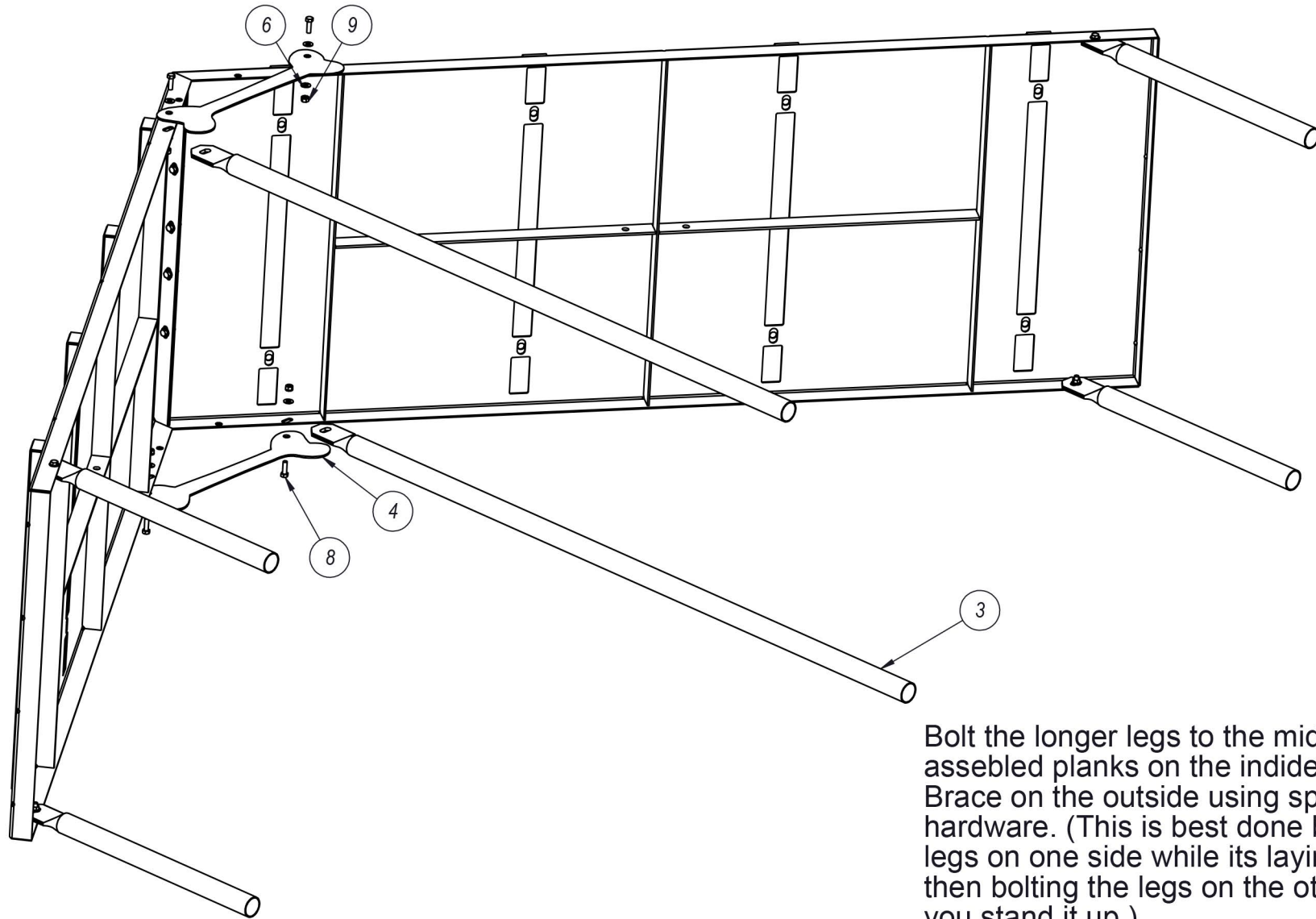

Bolt the longer legs to the middle of the assembled planks on the inside and the Bone Brace on the outside using specified hardware. (This is best done by bolting the legs on one side while it's laying down and then bolting the legs on the other side after you stand it up.)

STEP 4

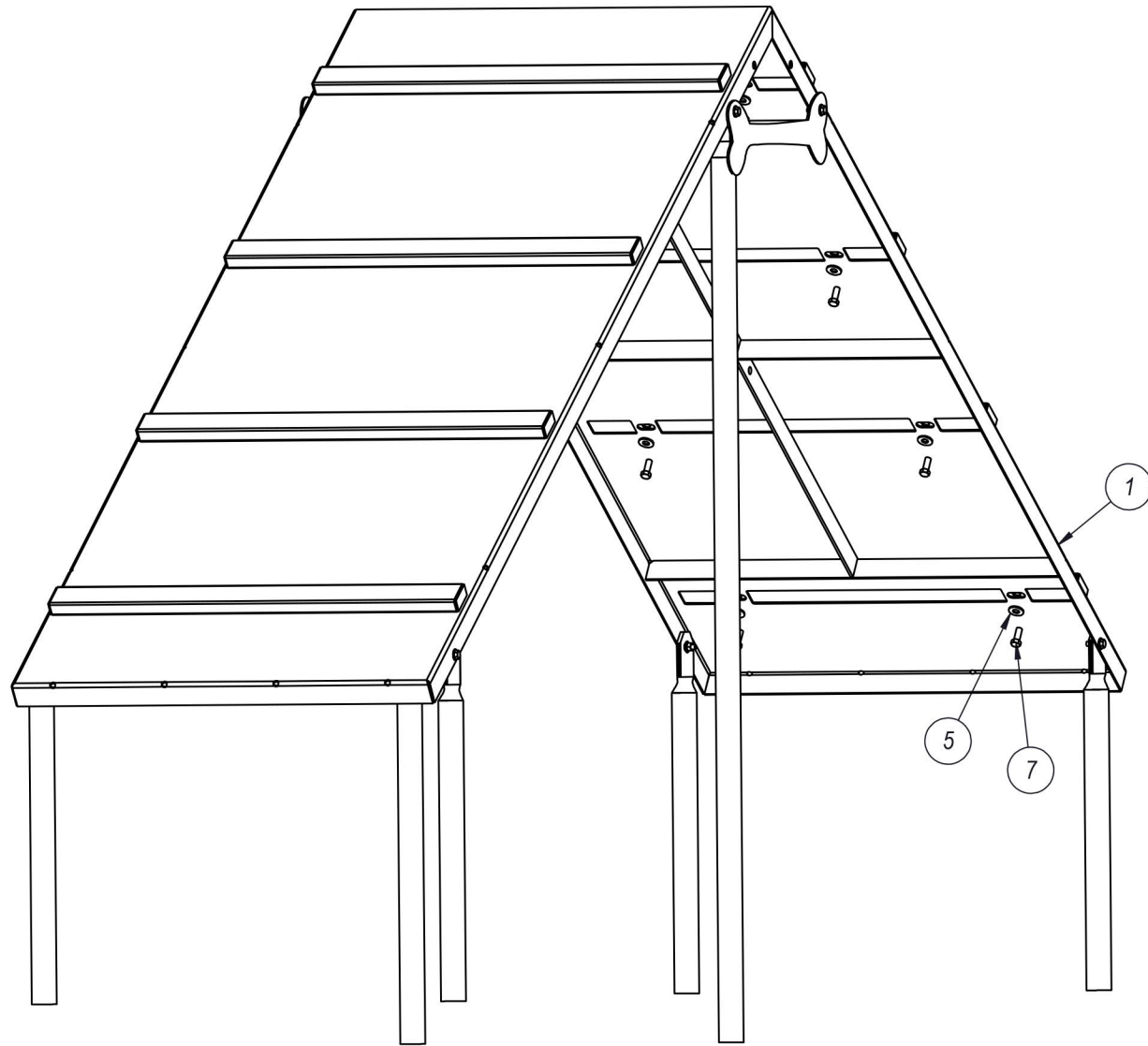

Attach the Step Strips
using specified
hardware.

FOOTINGS

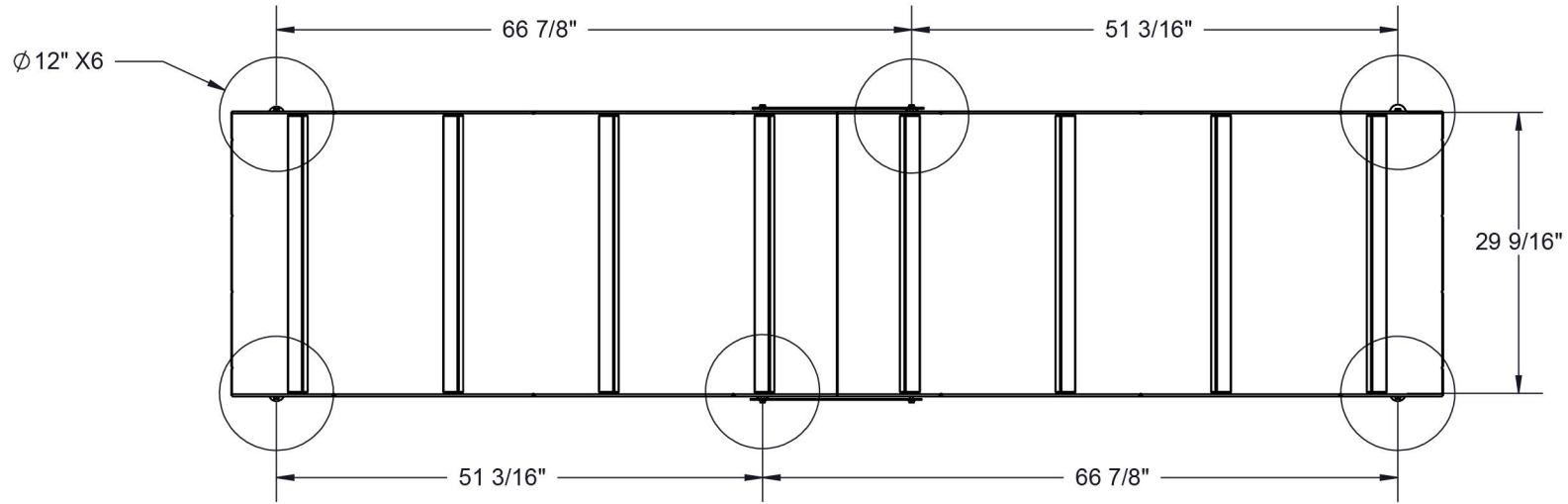

Estimated Required Concrete:
26 - 50 lb. bags of concrete mix

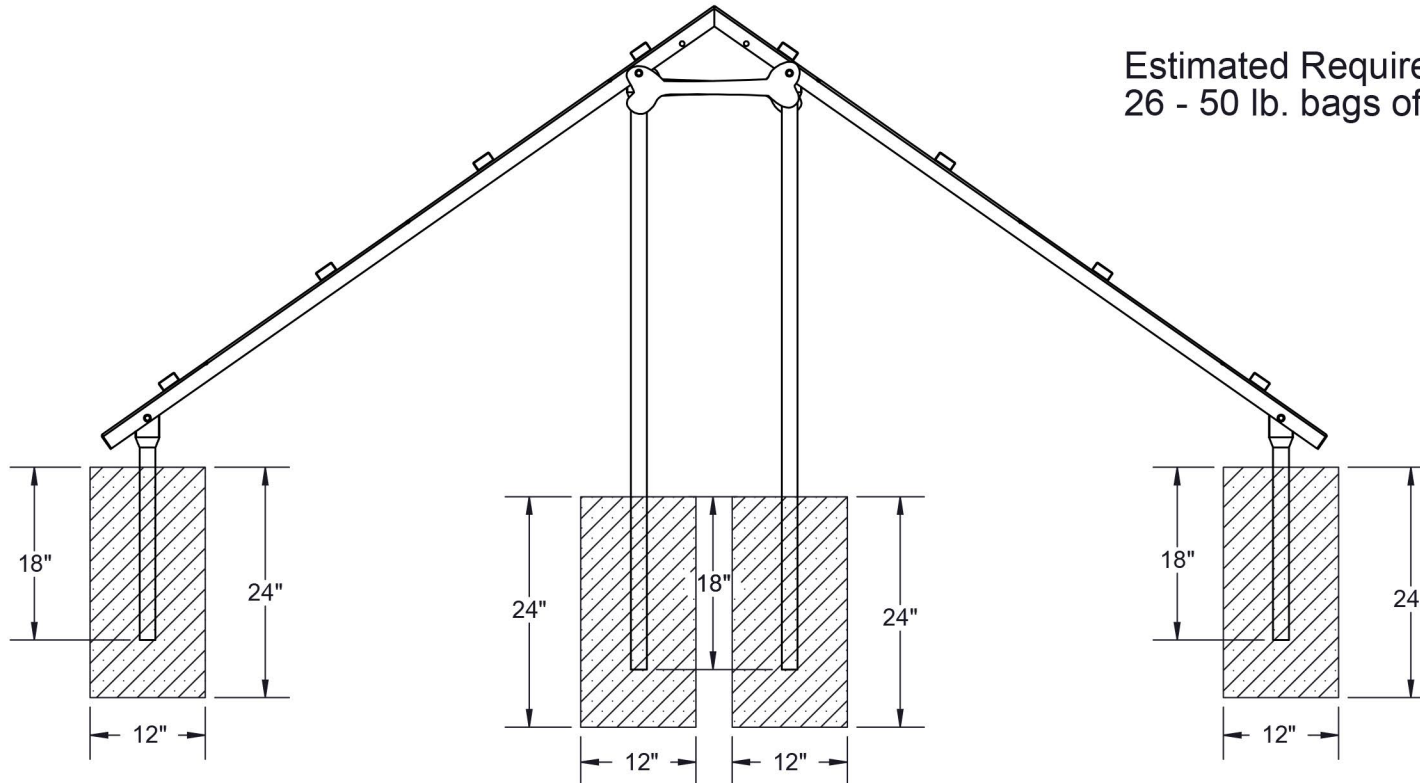

OVERALL DIMENSIONS

